

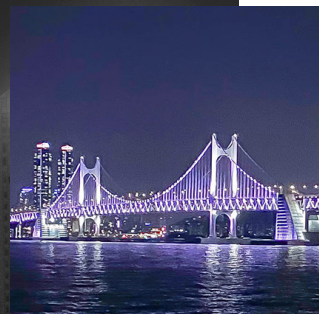

PARK HYATT BUSAN



the CITY

DYNAMIC BUSAN, A THRIVING
HUB OF TRADE AND TOURISM

Busan, a bustling city of approximately 3.4 million people, is located on the southeastern tip of the Korean Peninsula. The second largest city in South Korea, with its deep harbor and gentle tides have allowed it to grow into the biggest container handling port in the country and the fifth largest in the world.

Busan's natural charm and rich history have won a reputation as a world-class city of tourism and culture, while Busan is also emerging as a major international convention destination.



PH NOTE
Dongbaek Island,
Gwangan Bridge,
Haeundae Beach,
Haedong Yonggung Temple



GWANGAN BRIDGE

This Busan landmark shows the unending horizon of the ocean. During the daytime it displays grandeur through its harmony with the natural surroundings; after sunset it is a romantic venue offering glorious nighttime views.

DONGBAEK ISLAND

Located between Park Hyatt Busan and Haeundae Beach, this natural park is famous for its beautiful walking trails covered by dense camellia and pine trees. The lighthouse is an attraction for memorable photo opportunities.

HAEUNDAE BEACH

Haeundae Beach, the most famous beach in South Korea, has both natural beauty and historical background. Various culture and art events are regularly held. The area is an international tourist attraction.

HAEDONG YONGGUNG TEMPLE

Founded in 1376, this large temple is one of a few in South Korea to be set on the seaside. It is very popular, particularly during Buddha's Birthday when decorated with paper lanterns. It is also nice to enjoy the sunrise here.

PH NOTE

*Sunset view from Park Hyatt Busan,
night view of Marine City, Busan Fireworks Festival*

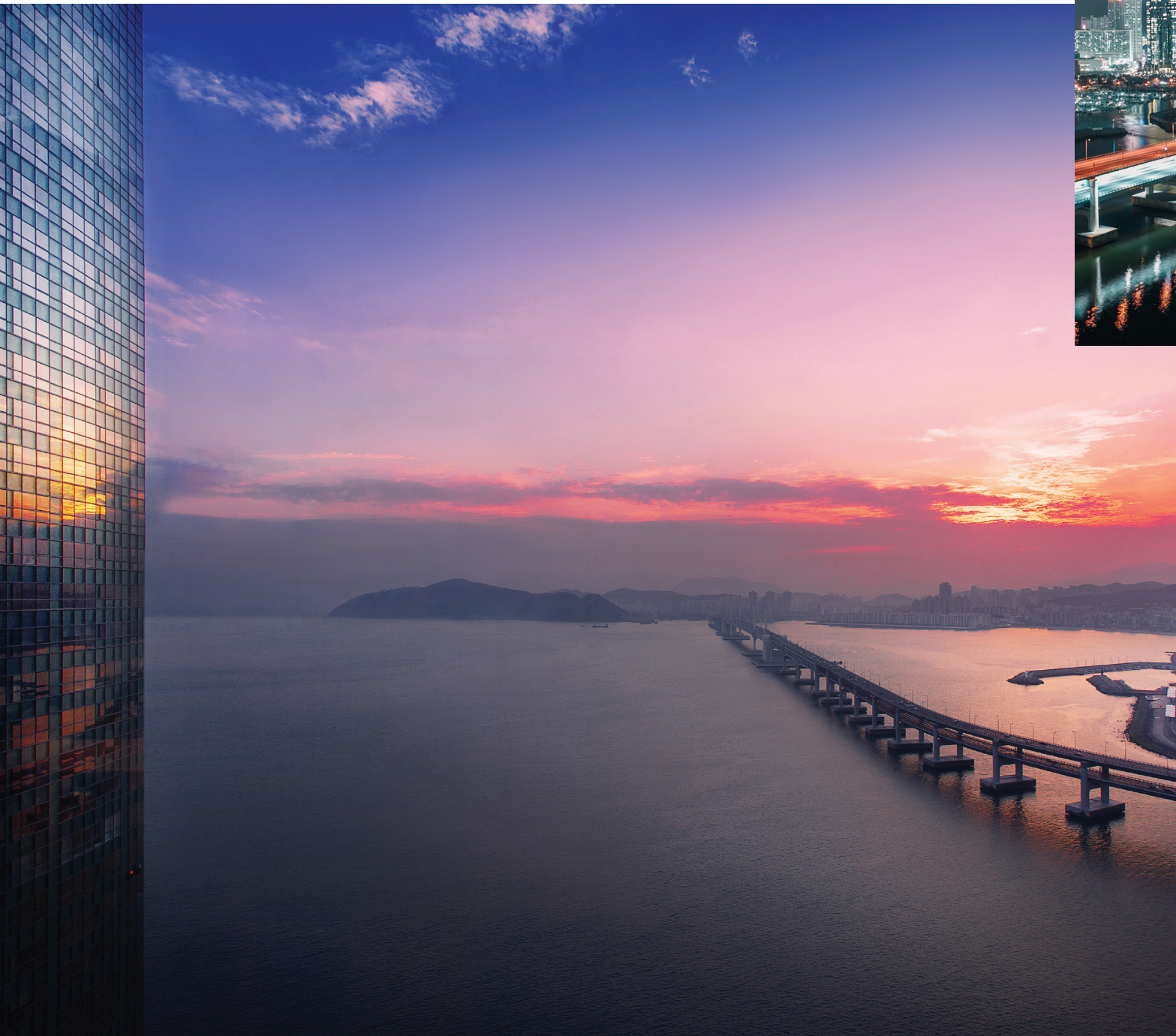



the PARK

A LUXURIOUS LANDMARK OF
WORLD-CLASS ARCHITECTURE

Situated in the heart of Haeundae District, the city's premier shopping and beach destination, alongside world-class shopping malls and BEXCO, Busan Exhibition and Convention Center, Park Hyatt Busan presents the ideal destination for sophisticated luxury travelers visiting Busan, South Korea's second largest city, for business or leisure. Designed by Daniel Libeskind and Super Potato, Park Hyatt Busan is a high-rise tower with a premier oceanfront location that comes with scenic views of Gwangan Bridge, the boundless ocean beyond, the yacht marina and the overall city skyline.



A CONTEMPORARY OASIS OF UNMATCHING VENUES

Embodying a vision of residential comfort, Park Hyatt Busan sources handpicked eco-friendly materials such as granite and French oak hardwood, employed to conjure a stylish yet comfortable ambience that blends seamlessly with a contemporary design philosophy.

Guestrooms are crafted as if to transport unaltered scenes of nature into an indoor setting, promising guests enriching experiences of comfort and relaxation during each stay.

The lobby, situated on the 30th floor, is the first space to greet arriving guests, revealing breathtaking ocean views even before check-in. This artful detail is crafted to leave every guest with an unforgettable impression of their very first encounter with the hotel.

Welcome to a world of exception.
Welcome to Park Hyatt Busan.



*Entrance with fountain inspired by seashell,
bathroom in Presidential Suite, bedroom in Park Executive Family Suite*



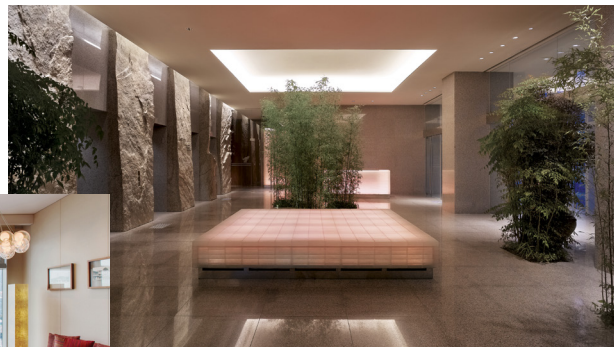

*Welcome to Park Hyatt.
A place where rare and
unexpected pleasures are
artfully woven into every
stay and guests unlock
unique and enriching
moments.*

Park Hyatt Busan offers 269 guestrooms, including 69 suites. Every single aspect of the hotel is carefully designed to ensure unmatched privacy. Upon stepping into a guestroom decorated in beige-toned woods, guests are met by inspiring views through floor-to-ceiling windows.

Spacious bathrooms with bathtubs and separate rain showers further elevate the comfort. An inbuilt 23-inch TV is available in every bathroom, accompanied by a selection of amenities by Le Labo, the exclusive skincare brand offered at Park Hyatt hotels around the world.

Each guestroom features an array of comforts carefully curated to intuitively meet the unspoken needs of each guest, including a 50-inch or larger smart TV, Bluetooth speaker, premium capsule coffee machine, thoughtfully stocked minibar, individual room temperature controller, telephone and wireless internet. Through a 24-hour room service, guests can take full advantage of the highest quality dining in the privacy of their rooms.

ACCOMMODATION

- 269 guestrooms including 69 suites
- Stunning views over the ocean, Gwangan Bridge and the yacht marina through floor-to-ceiling windows
- Guestrooms with a 50-inch or larger smart TV, Bluetooth speaker and premium capsule coffee machine
- Spacious bathroom with an inbuilt 23-inch TV, large bathtub and separate rain shower
- High-speed wireless internet access
- Business hub with USB, audio and HDMI connections
- Individual climate control
- Remote blinds and mood lighting, all controlled from the bedside table
- In-room safe
- Private minibar
- Specially equipped guestrooms for guests with special needs

SERVICES AND FACILITIES

- Lobby located on the 30th floor
- 24-hour business center
- 24-hour duty manager
- 24-hour concierge service
- 24-hour room service
- Laundry and dry-cleaning services
- Private limousine service
- Valet parking
- Underground car park
- Safe deposit box
- Currency exchange



life STYLE

EXTRAORDINARY EXPERIENCES OF
FOOD AND WINE

Upholding the Park Hyatt reputation for setting new dining trends through innovative culinary concepts, Park Hyatt Busan offers guests epicurean experiences at its portfolio of restaurants - Dining Room, Living Room, Living Room Bar, Lounge and Patisserie.

Park Hyatt Busan's chefs, renowned for their innovative style and ability to conjure fresh and timeless flavors with modern flair, holding the key to the Park Hyatt culinary experience. Immersed in the exceptional ambiances of our restaurant collection, your experience will truly embody the art of dining.

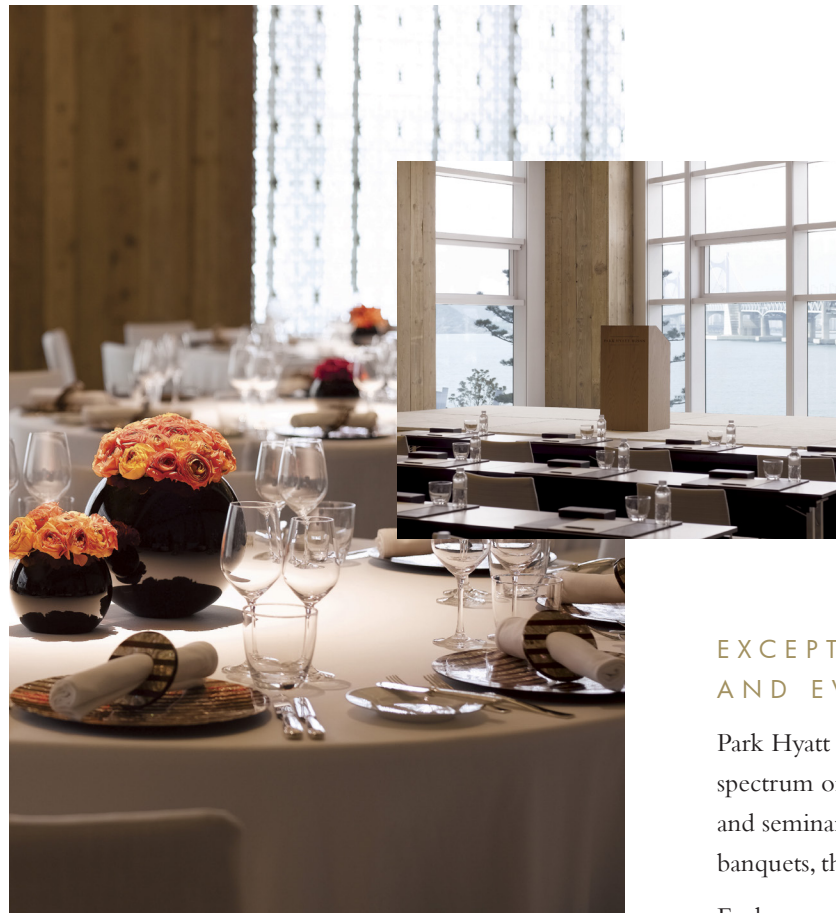

EXCEPTIONAL MEETINGS AND EVENTS

Park Hyatt Busan provides venues optimized for a diverse spectrum of events, from corporate meetings, conferences and seminars to social gatherings such as weddings, banquets, themed parties and other functions.

Each venue is equipped with competitive technology, complemented by a sense of warmth and familiarity that embodies the hotel's vision of style and elegance.





A PLACE OF PERFECT RELAXATION AND RENEWAL

Blending the radiance of the sun with the beauty of the earth, ultimate serenity in Busan exists at Lumi Spa & Fitness. With views of the ocean and majestic Gwangan Bridge, Lumi Spa & Fitness offers unparalleled luxury in beauty and body treatments.

Lumi Spa & Fitness promises each guest timeless comfort, rest and relaxation, as if enveloped by warm sunlight, wind, ocean and mountain backdrops in a soothing indoor setting.



PH NOTE

*Spa treatment room, Living Room Bar and
Drawing Room with a splendid night view of Gwangan Bridge*

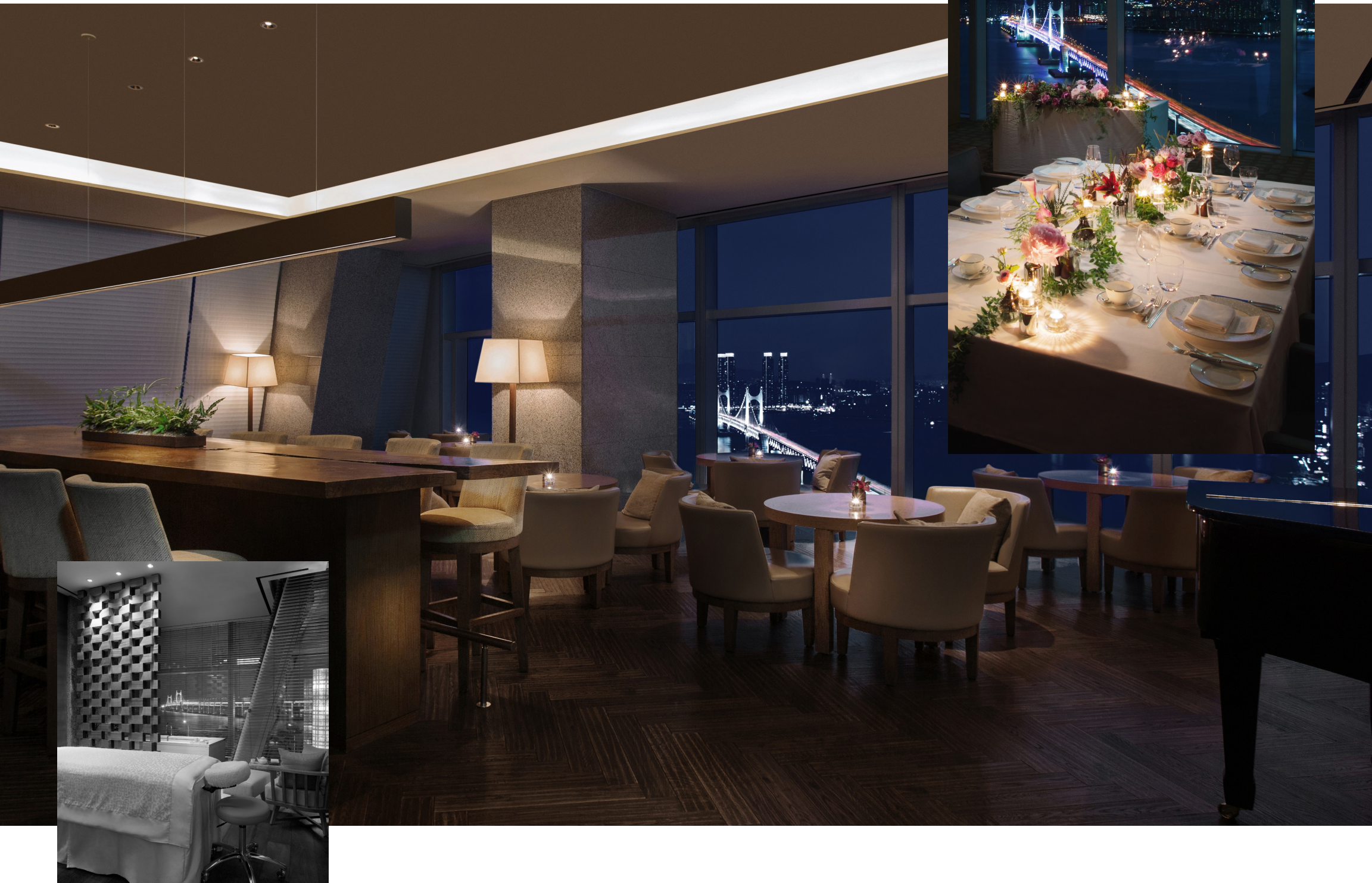



*Discover carefully
crafted food and
perfectly-paired wine.*

*Enjoy warm and
dignified services that
ensures all is always as it
should be.*

RESTAURANTS AND BAR

- Dining Room (32F): The Steak & Seafood Grill restaurant, with an open kitchen, provides a selection of premium steak and fresh seafood as well as Korean cuisine reinterpreted in Park Hyatt style.
- Living Room (31F): The Italian restaurant with its cozy, yet vibrant environment offers authentic Italian cuisine from a selection of traditional recipes and high-quality local ingredients. Dine along the panoramic view or relax around the open fire place.
- Living Room Bar (31F): The bar offers cocktails, wines, whiskies and snacks with splendid views of Gwangang Bridge, accompanied with seasonal live music.
- Lounge (30F): An ideal meeting place and a perfect location for casual conversations. It offers seasonal afternoon tea sets, an extensive collection of snacks and beverages with breathtaking views.
- Patisserie (1F): The pastry boutique specializes in homemade cakes, breads, pastries, chocolates, sandwiches, salads and other retail items, all served with premium coffees, teas and juices. All to be enjoyed directly at Patisserie, its outdoor terrace or conveniently as take-away.





MEETINGS AND EVENTS

- Drawing Room (33F): Situated on the top floor of the hotel, Drawing Room features beautiful views of the ocean, Gwangang Bridge and the yacht marina. Comprised of four rooms with a total capacity for up to 76 guests, it is a premium venue for intimate events.
- Ballroom (2F): A prestigious venue for larger events and exhibitions with a ceiling height of 4.6m, Ballroom features modern Korean interior design, natural lighting through floor-to-ceiling windows with inbuilt audio and video equipment. Capable of accommodating up to 260 guests, Ballroom comes with a foyer and an exclusive Event Suite.
- Salon (1F): Equipped with inbuilt service stations, TVs, LED projectors, screens and sound system, Salon, consisting of five rooms, all with natural light, is a residential style venue which caters to events from 10 to 70 guests.

LUMI SPA & FITNESS

- Fitness Center (5F): Occupying the entire ocean front with wooden floors and inbuilt hydration stations, Fitness Center offers a wide range of exercise machines. Private studios offer various physical activity programs.
- Swimming Pool (4F): Based on the concept of bringing the outdoors indoors, it offers ocean views through floor-to-ceiling windows. A natural forest flourishes under the glass ceiling roof arching over the 22m long pool.
- Sauna (4F): A private place for relaxation with personal shower booths, dry and steamed sauna rooms, hot and cold tubs, large personal lockers, as well as a variety of skin care amenities.
- Spa (3F): With seven private spa treatment rooms featuring picturesque views, Spa restores calmness and tranquility for body and mind. All treatments are performed by expert therapists with the highest standards.

ROOM DIMENSIONS & CAPACITIES

ROOM NAME	ROOM DIMENSIONS L x W x H	SQUARE METER	BANQUET	RECEPTION	THEATER	CLASSROOM	BOARD ROOM	U-SHAPE
LEVEL								
LEVEL 1								
SALON 1	9M X 7M X 4.4M	59	-	-	-	-	-	-
SALON 2	9M X 5.6M X 4.4M	50	20	20	24	16	16	14
SALON 3	9M X 5.5M X 4.4M	45	20	20	24	16	14	14
SALON 4	8.3M X 5.5M X 4.4M	44	20	20	24	16	14	14
SALON 5	7.4M X 5.3M X 4.4M	31	12	12	20	12	10	10
SALON 3+4+5	9M X 16.6M X 4.4M	12	60	70	80	36	32	34
SALON 2+3+4+5	9M X 21.2M X 4.4M	170	80	100	100	66	44	46
LEVEL 2								
BALLROOM 1	17.1M X 13.2M X 4.6M	184	100	150	150	90	32	39
BALLROOM 2	10.2M X 13.2M X 4.6M	126	80	100	100	60	24	33
BALLROOM 3	10.7M X 12.7M X 4.6M	128	80	100	100	60	24	33
BALLROOM 1+2+3	38.1M X 13.2M X 4.6M	438	260	350	350	200	80	90
BALLROOM FOYER	14.3M X 11M X 4.6M	152	-	100	-	-	-	-
LEVEL 3 3								
DRAWING ROOM 1	8.3M X 10.2M X 3M	78	30	40	40	24	18	16
DRAWING ROOM 2	5.5M X 11.9M X 3M	50	20	20	20	12	16	14
DRAWING ROOM 3	8.4M X 7.9M X 3M	58	30	30	30	18	14	16
DRAWING ROOM 4	8.7M X 9M X 3M	53	20	25	20	18	14	12
DRAWING ROOM 1+2+3+4	8.7M X 11.9M X 3M	239	100	115	110	72	62	58

FLOOR PLAN

LEVEL 1

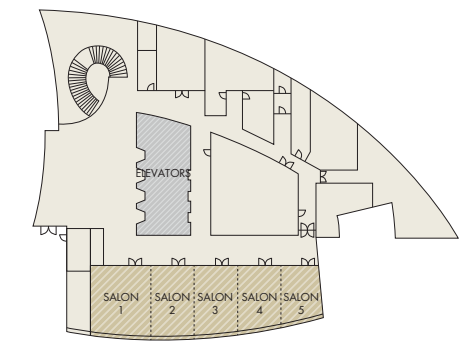

LEVEL 2

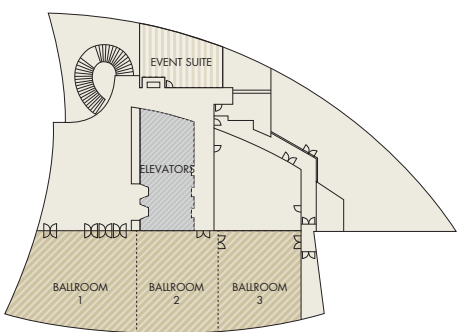

LEVEL 3 3

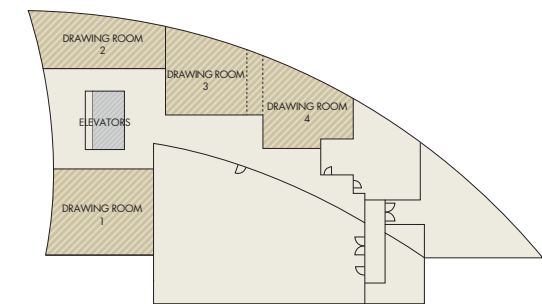



MASTERS OF FOOD & WINE

Park Hyatt Masters of Food & Wine is a series of sophisticated culinary and beverage experiences hosted at selected Park Hyatt locations. Through engaging and interactive events, local residents and visiting gourmands can connect with our award-winning chefs, sommeliers, and specialists.



CREATIVE ART

Each Park Hyatt hotel shares our passion for the arts by creating unique events for both guests and locals to enjoy. From hosting art fairs to unveiling works of art on our walls, we invite our guests to embark on artistic journeys of discovery. Park Hyatt hotels maintain close relationships with many of the artists featured in our hotels. Whenever possible, we take the opportunity to bring these artists to meet our guests and share their insights into the works on display.



PARK HYATT AROUND THE WORLD

Since its inception, Park Hyatt has quickly expanded across the globe but stayed true to its founding philosophy: to provide highly personalized service and world class food and wine while embodying understated luxury.



AFRICA

PARK HYATT ZANZIBAR

ASIA

PARK HYATT BANGKOK
PARK HYATT BEIJING
PARK HYATT BUSAN
PARK HYATT CHANGBAISHAN
PARK HYATT CHENNAI
PARK HYATT GUANGZHOU
PARK HYATT HANGZHOU
PARK HYATT HYDERABAD
PARK HYATT KYOTO
PARK HYATT MALDIVES HADAHAA
PARK HYATT NINGBO RESORT AND SPA
PARK HYATT NISEKO HANAZONO
PARK HYATT SAIGON
PARK HYATT SANYA SUNNY BAY RESORT
PARK HYATT SEOUL
PARK HYATT SHANGHAI
PARK HYATT SHENZHEN
PARK HYATT SIEM REAP
PARK HYATT TOKYO

AUSTRALIA & PACIFIC

HYATT HOTEL CANBERRA – A PARK HYATT HOTEL
PARK HYATT MELBOURNE
PARK HYATT SYDNEY

CARIBBEAN

PARK HYATT ST. KITTS CHRISTOPHE HARBOUR

EUROPE

ARARAT PARK HYATT MOSCOW
PARK HYATT HAMBURG
PARK HYATT ISTANBUL – MAÇKA PALAS
PARK HYATT MALLORCA
PARK HYATT MILAN
PARK HYATT PARIS – VENDÔME
PARK HYATT VIENNA
PARK HYATT ZURICH

LATIN AMERICA

PALACIO DUHAU – PARK HYATT BUENOS AIRES
PARK HYATT MENDOZA HOTEL, CASINO AND SPA

MIDDLE EAST

PARK HYATT ABU DHABI HOTEL AND VILLAS
PARK HYATT DOHA
PARK HYATT DUBAI
PARK HYATT JEDDAH – MARINA, CLUB AND SPA

NORTH AMERICA

PARK HYATT AVIARA RESORT, GOLF CLUB AND SPA
PARK HYATT BEAVER CREEK RESORT AND SPA
PARK HYATT CHICAGO
PARK HYATT NEW YORK
PARK HYATT WASHINGTON, D.C.

DEBUTING SOON*

PARK HYATT AUCKLAND**
PARK HYATT JAKARTA**
PARK HYATT KUALA LUMPUR
PARK HYATT LOS CABOS
PARK HYATT MEXICO CITY
PARK HYATT TAIPEI
PARK HYATT TORONTO**
PARK HYATT SUZHOU

LUXURY IS PERSONAL

* Opening dates subject to change.
** Opening 2020

